

# QUICKCONNECT WATER FILTRATION SYSTEM TANKLESS REVERSE OSMOSIS SYSTEM INSTALLATION AND OPERATION MANUAL

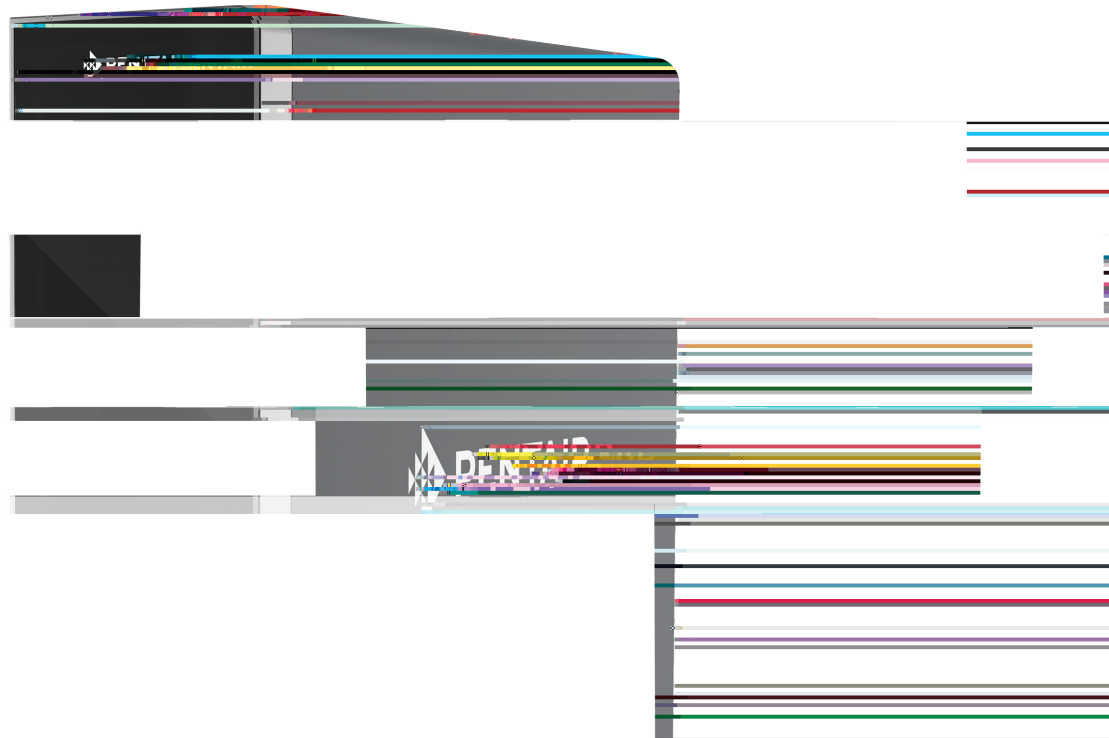

---

· x; s; s%a; ÈY.....	3
Parts Included.....	3
Tools and Materials Required .....	3
Precautions .....	3
How Reverse Osmosis Works	

---

---

Improper connection of the appliance-grounding conductor can result in a risk of electric shock. Check with a voltage tester whether the appliance is properly grounded. Do not modify the plug attachment plug to pass through the partition. The longest dimension of the opening shall not be more than 1-1/2 in (38 mm);

- A. The power-supply receptacle for the appliance shall be installed in a cabinet or on a wall adjacent to the undercounter space in which the appliance is to be installed;
- B. There shall be an opening through the partition between the attachment plug to pass through. The longest dimension of the opening shall not be more than 1-1/2 in (38 mm);
- C. If the partition is wood, be smooth and rounded, or, if the partition is metal, be covered with an edge protector provided for this purpose by the manufacturer; and
- D. Care shall be exercised, when the appliance is installed or

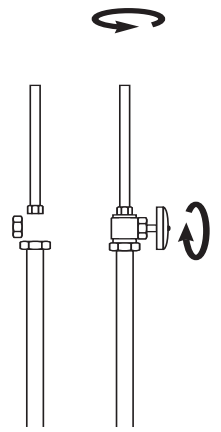

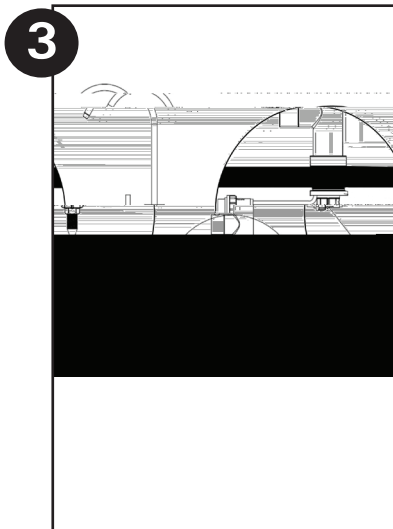

Not all parts provided with the faucet may be needed for installation.

Slide chrome plate and black rubber washer onto faucet by threading both drain tubes through the holes on the plate and washer.

Slide white extension spacer onto long threaded section of faucet. Open end of extension should come in contact with base of faucet.

Screw washer, and locking nut onto end of faucet threads.

Screw quick connector onto end of faucet threads.

Wet end of 1/4" white tube. Push into bottom of quick connector. Tug gently to be sure connection is complete. Insert 1/4" quick coupling lock plate between quick connect port and claw of tubing.

Holding the faucet, feed the tube through the hole in the sink. Position the faucet handle at a desired location.

Center the faucet. Tighten the locking nut with a wrench until it is tight.

If you have a single-basin sink with a disposal unit, call Technical Support for options.

Before installing the drain clamp, check the drainpipes under the sink for corrosion. Corroded pipes should be replaced before continuing with installation.

Attach the drain clamp to a vertical section of the drainpipe, about 6" above the trap. Make sure the opening on the drain clamp is facing towards the drinking water faucet.

Remove the drain clamp from the drainpipe and enlarge the hole with a 3/8" drill bit.

Make sure the black rubber gasket is adhered to the inside of the drain clamp and place the drain clamp assembly over the drilled hole. Look through the hole and position the clamp so that the center of the clamp hole is slightly higher (about 1/16") than the center of the drilled hole. Tighten the clamp securely.

Screw the plastic compression nut onto the drain clamp until hand-tight.

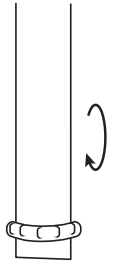

This is a gravity drain line. Any loops, kinks or sharp bends must be eliminated before proceeding.

Locate the 1/4" red tubing.

Insert one end of the tubing into the "Drain" port on the back of the system.

Insert 1/4" quick coupling lock plate between the quick coupling and the jack catch of the tubing.

Run the other end of the tubing to the desired drain location.

When selecting an installation location of the system, take into consideration the length of tubing required for connection between components. Some installation sites may require more tubing than provided in the kit.

Select a location under the sink, or other suitable area where the system will be installed.

The system carton can be used to determine the operational footprint required for installation of the system and replacement cartridges. (Figure 6) Carton is oversized 4-6" in each direction for packing materials.

weight of the system.

---

Determine the length of plastic white tubing needed to connect from the system to the faucet. Be sure to allow enough tubing to prevent kinking and cut the tubing squarely. Use a marker to mark one end of the tubing 5/8" from the end. Wet the end of the 1/4" tube and push into the port on the back of the system labeled "Drinking Faucet". Insert 1/4" quick coupling lock plate between quick connect port and claw of tubing.

Do not bend or crimp tube while inserting.

Gently pull back on the tube to ensure it is connected properly.





Timeout fault	Ú c ƒ c \$ % Ú' %'	Go out	Power off and then power back on the system
Frequent start-stop	×ãÚÀ ƒ c \$ % Ú' %'	Go out	Power off and then power back on the system
Water leakage	Ú c ƒ c \$ % Ú' %'	]   c ƒ c \$ % Ú' %'	Locate and repair water leak
Low temperature	ƒ c \$ % Ú' %'	]   c ƒ c \$ % Ú' %'	Power off and then power back on the system

			Filter cartridge indicator	Buzzer
Normal	Greater than 15 days	Greater than 150 liters	Continuous Blue light on	No warning reminder
Early Warning	Greater than 0 and less than 15 days	Greater than 0 and less than 15 liters	Continuous Purple light on	Beeps twice during water production (beep 0.3 seconds, stop 1 second)
Alarming	Zero days	Zero	Continuous Red light on	Beeps during production (beep 0.3 seconds, stop 1 second)

Blue < 100 ppm	Purple > 100 < 150 ppm	Red > 150 ppm
----------------	------------------------	---------------



If high levels of TDS (Total Dissolved Solids) are detected in your product water as determined by a TDS Monitor, the cartridge membrane may need to be replaced. See your dealer or plumber to check product water TDS.

Gradual return of unpleasant taste and odor over a period of time may indicate that your cartridges need to be replaced.

If shortly after complete servicing noticeable taste and odors return, contact Technical Support.

1. Relieve pressure by turning off the water supply to the system. Place a towel under the system to catch any water drips.
2. Depress plastic collar and pull out tubing. Cut off 1" of tubing and place a mark 5/8" from end of tubing. Tubing should be cut squarely. The internal and external burrs should be removed.
3. Open the cold water supply. If leaks persist, call Technical Support at 1-800-279-9404.

1. Close the cold water supply.
2. Depress plastic collar and pull out tubing.
3. Cut off 1" of tubing and place a mark 5/8" from end of tubing. Tubing should be cut squarely. The internal and external burrs should be removed.
5. Open the cold water supply. If leaks persist, call Technical Support.

---

4006967	SMART FAUCET	1	//

For replacement parts, call

Read this performance data and compare the capabilities of this system with your actual water treatment needs. The Tankless RO system contains a replaceable treatment component, critical for the effective reduction of TDS and that product water shall be tested periodically to verify that the system is performing properly.

It is recommended that before installing a water treatment system, you have your water supply tested to determine your actual water treatment needs.

This system has been tested according to NSF/ANSI 58 for the reduction of substances listed below. The concentration of the indicated substances in water entering the system was reduced to a concentration less than or equal to the permissible limit for water

Do not use with water that is microbiologically unsafe or of unknown quality without adequate disinfection before or after the system.

Substances reduced are not necessarily in your water. Filter must be maintained according to manufacturer's instructions,



against NSF/ANSI Standard 58 for the reduction of the substances listed below.





For Pentair® Product Warranties visit:  
Pentair para las garantías de los productos visite: }  
Pour Pentair garanties produit visitez le site: }